



M24 BB86 ROAD OR M24 BB90/92 MTB

For M24 Road or MTB Cranks
and SRAM GXP™ Cranksets

SAFETY INFORMATION - READ BEFORE RIDE

Since specific tools and experience are necessary for proper installation, it is recommended that the product be installed by a qualified bicycle technician.

Read the service instructions of your crank carefully prior to installing the parts. Loose, worn or damaged parts may cause riding problems and serious injury may occur as a result. If installation and adjustments are not carried out correctly, the chain may come off and this may cause you to fall off the bicycle which could result in serious injury. **Read these instructions carefully, and keep them for later use.**

- Ensure that your PF frame shell is clean and free of debris.
- Before riding the bicycle, check that there is no play or looseness in the bottom bracket connection. Also, be sure to retighten the crankarms and pedals at periodic intervals.
- If you feel any looseness or 'play' in the bearings, the bottom bracket should be inspected/replaced.
- Be sure to read the instructions for your front chainrings/crank in conjunction with these service instructions.
- **Do not wash the bottom bracket with high-pressure jets of water.**
- For maximum performance it is required to remove and periodically inspect/clean your Praxis Works bottom bracket.
- **Parts are not guaranteed against natural wear or deterioration resulting from normal use.**
- For any questions regarding methods of installation, adjustment, maintenance or operation, please contact a professional bicycle dealer or call Praxis Works.
- Praxis Works assumes no responsibility for damages or injury related to improperly installed components.

READ THE STEP BY STEP INSTRUCTIONS PROVIDED ON THE OTHER SIDE.

WARRANTY

- Praxis Works Bottom Bracket products are warranted to be free from defects in materials or workmanship for two years after original purchase. The warranty is non-transferable and valid to the original purchaser of the product only.
- Any attempt to modify the product in any way such as drilling, grinding or painting will void the warranty.
- This warranty is not valid for "abused" or neglected products, or products that are damaged by improper installation.
- If a defect is found, our entire liability and your sole remedy shall be, at our option, free repair or replacement of the Praxis product.
- Except as expressly required by law, Praxis Works shall not be held liable for any indirect, special, or consequential damages.

THIS WRITTEN EXPRESS WARRANTY IS IN LIEU OF ALL OTHER WARRANTIES, IMPLIED OR EXPRESSED. This warranty gives you specific legal rights, and you may also have other rights which vary state to state. **For more information on warranty policy and instructions for completing a warranty claim, check out the Full Warranty Policy found at our website. www.praxis-works.com**

M24 BB86/90/92 Compatibility and Spec

| | |
|------------------|---|
| CRANKSET | Compatible with Praxis M24 Based Cranks and SRAM GXP™ cranksets BB86 for ROAD Cranks only - BB90/92 for MTB Cranks only |
| FRAME SHELL | BB86 ROAD Frames BB90/92 MTB Frames - 41mm Diameter Frame Shell |
| FRONT DERAILLEUR | Braze-on or ST Clamp |

REQUIRED TOOLS

- Bearing Press Tool
- Hammer
- Loctite Superflex Clear RTV (Carbon BB Shell)
- Park Tool BBT-30.3 Bearing Remover

| Included Parts | | |
|----------------|--------------------------------|-----|
| Number | Part | Qty |
| 1 | 24mm ID Drive (RH) Bearing | 1 |
| 2 | 24mm ID X 2.0mm Dust Cover | 1 |
| 3 | 24mm ID X 3.7mm Dust Cover | 1 |
| 4 | 24mm ID X 6.8mm Dust Cover | 1 |
| 5 | Wave Washer | 1 |
| 6 | 22mm ID X 1.7mm Dust Cover | 1 |
| 7 | 22mm ID Non-Drive (LH) Bearing | 1 |

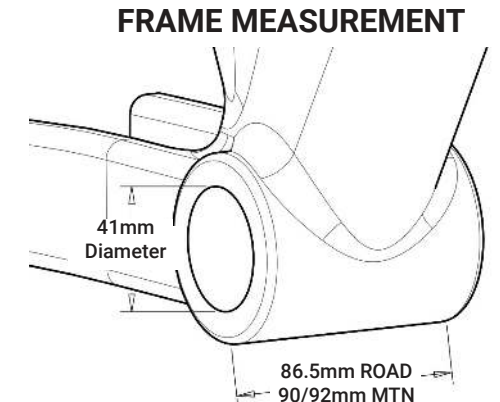
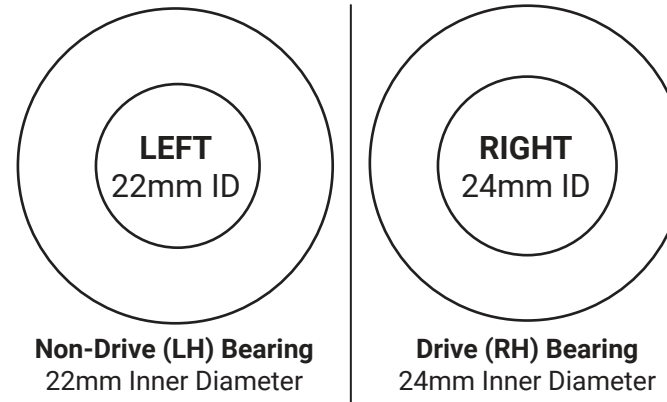
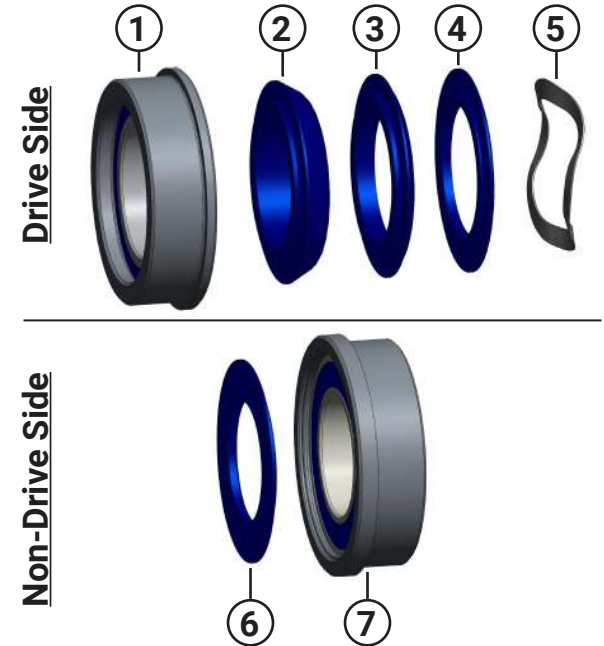

1. PREP

BB FRAME GAUGE

Please use the BB86/90/92 Frame Gauge to check that your BB shell is within tolerance prior to Praxis BB installation.

Using only **FINGER PRESSURE**, the frame gauge must slide into the BB86/90/92 frame bore completely for it to be a **GO** and ok for BB installation.



If the gauge only fits one side of the frame or is only slides in partially, it is a **NO-GO**. Do not force the gauge into the frame.

FRAME AND BB PREP

Loctite Superflex RTV Silicone (or similar RTV silicone) is to be used on both Aluminum and Carbon frames

1 Clean the BB shell using a solvent to remove any residual grease

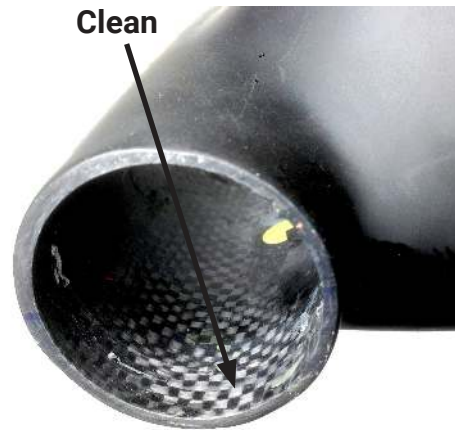

2 Use **Loctite Superflex RTV Silicone Adhesive (Room Temp Vulcanizing)** for all frame materials



3 Spread a **thin coat** of silicone around the BB shell and on the BB cup surface as shown

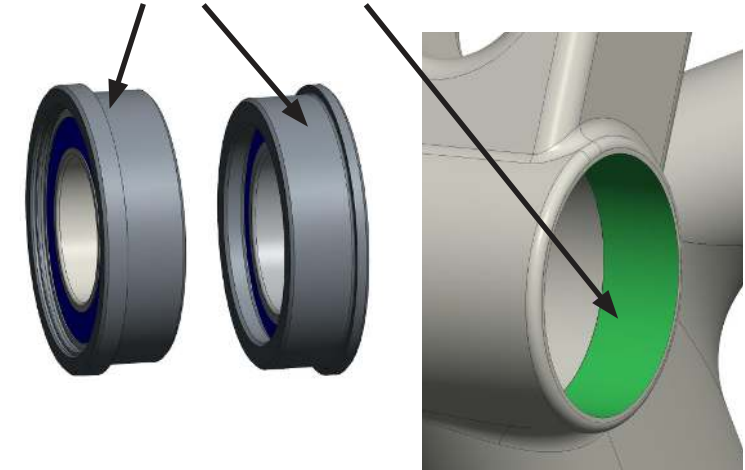

2. INSTALL

Installation Notes

- Press all bearings using a professional press tool.
- Press all bearings flush against the bottom bracket shell.
- **Press bearings one at a time**

- 1** Press the 22mm ID bearing into the Non-Drive side of the frame.
- 2** Then press the 24mm ID bearing into the Drive side of the frame.
- 3** Wait **24hrs for silicone to cure.**

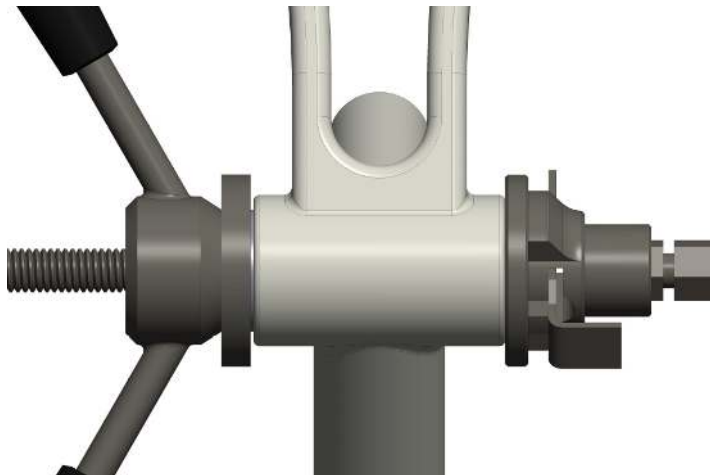

Pressed Flush

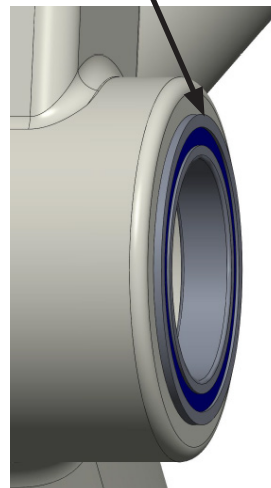

Praxis Drive Side Cover Setup Chart

| Crank | BB86 | BB90 | BB92 |
|---------------------|-----------------|-----------------|-----------------|
| STANDARD CRANKS | 24mm ID / 3.7mm | 24mm ID / 6.8mm | 24mm ID / 3.7mm |
| DIRECT MOUNT CRANKS | N/A | 24mm ID / 3.7mm | 24mm ID / 2.0mm |

Drive Side Dust Covers

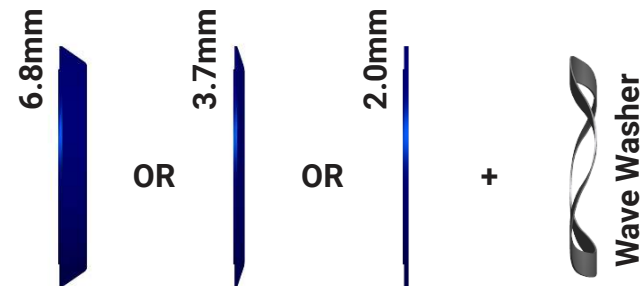

Use the 22mm ID X 1.7mm cover on the Non-Drive side

REMOVAL

Use **Park Tool BBT-30.3 Bearing Removal Tool** or a similar tool to remove bearings from BB shell.

- 1** Using bearing removal tool, hammer out the **Non-Drive Side Bearing** from the inside out.
- 2** Using bearing removal tool, hammer out the **Drive Side Bearing** from the inside out.

